

## PLMA's World of Private Label 29 - 30 May 2018

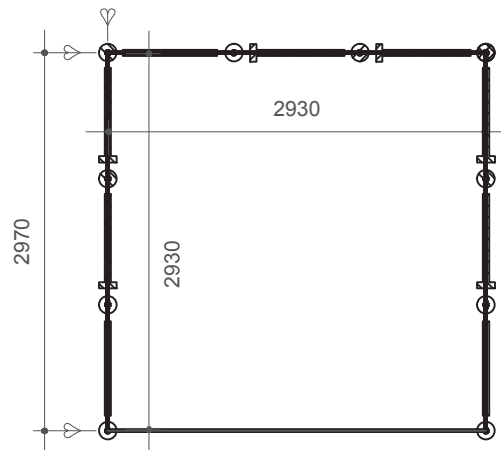
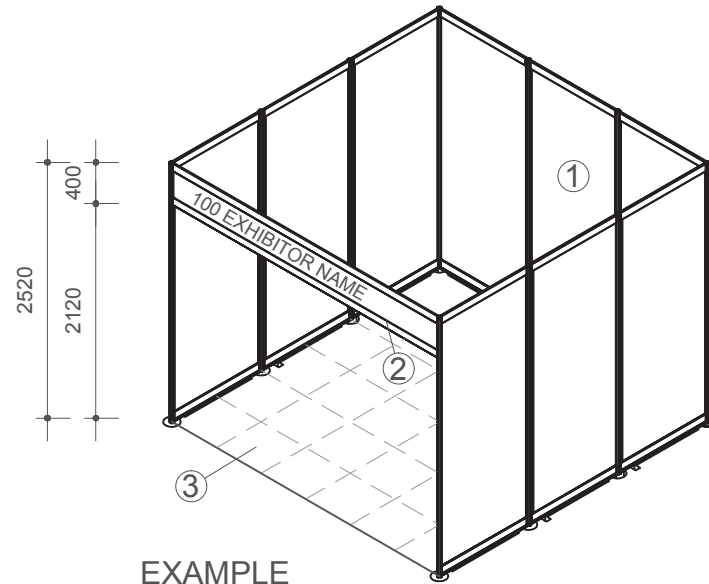

TOP VIEW / SPACE MEASUREMENTS

### SHELL SCHEME STAND EXAMPLE 1-Unit, 3x3 mtr. stand (one sides open)

- ① White walls, separating exhibitors
- ② Fascia, showing exhibitor name (as listed in the official trade show catalogue) and stand number
- ③ Grey carpet tiles

- Submit Shell Stand Form on PLMA's Exhibitor portal -

### CONTACT GIELISSEN FOR:

- \* Stand necessities: electricity & lighting, furniture, signage, audio-video, shell scheme additional, floor covering, raised floor, water, floral decoration, photography, man power
  - \* Position of nearest service ducts
  - \* Complete stand packages
- Submit Grid Form on Gielissen's Online Contractor Manual -

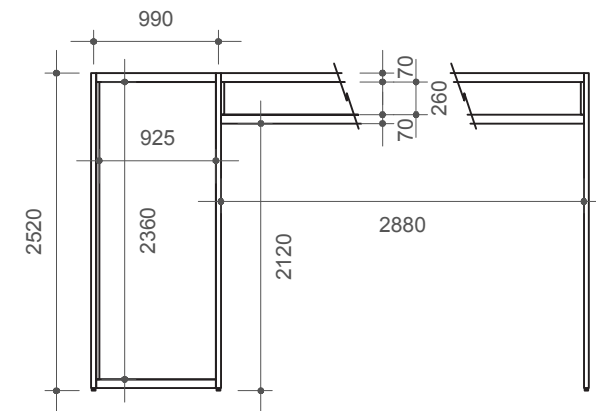

WALL AND FASCIA

# PLMA's World of Private Label 29 - 30 May 2018

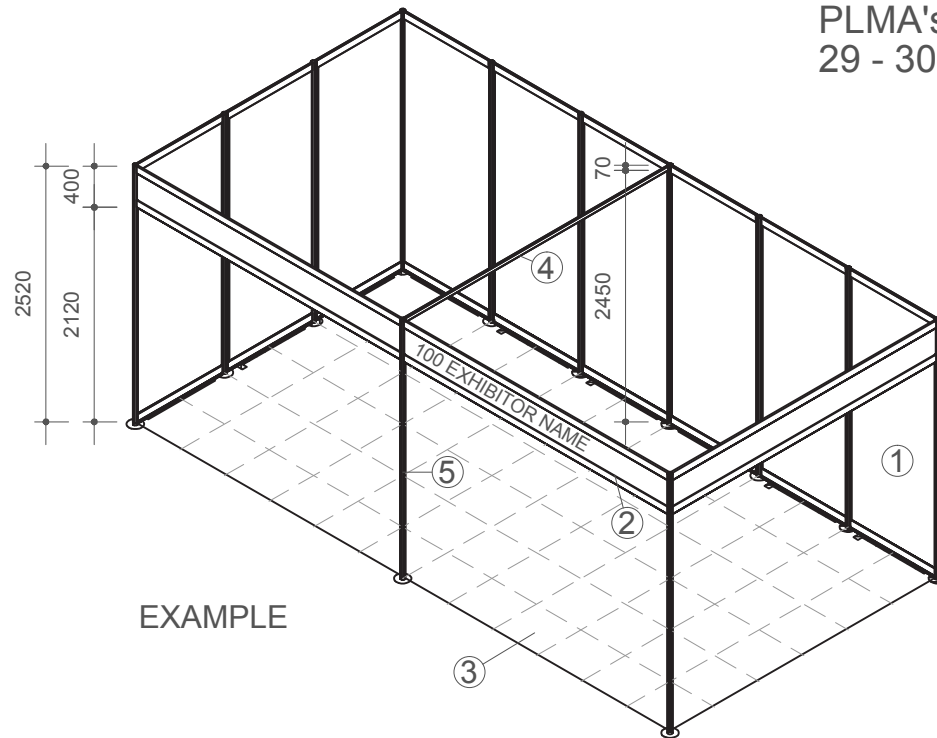

EXAMPLE

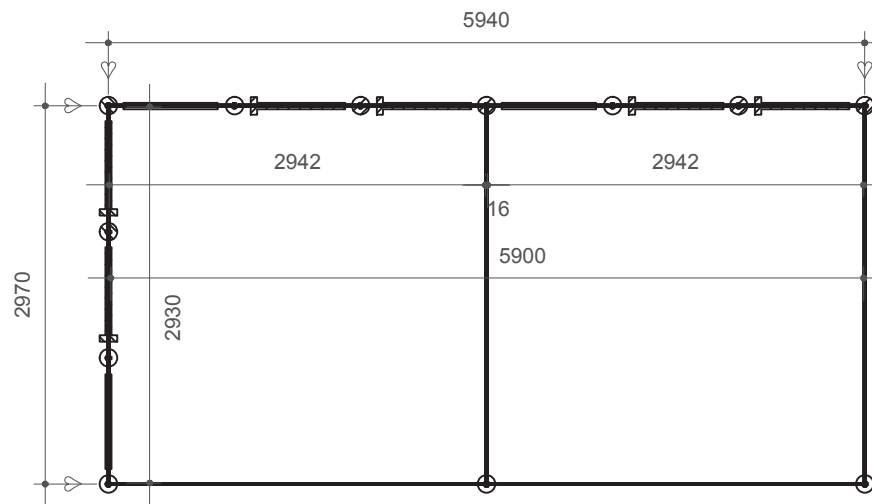

TOP VIEW / SPACE MEASUREMENTS

## SHELL SCHEME STAND EXAMPLE 2-Unit, 3x6 mtr. corner stand (two sides open)

- ① White walls, separating exhibitors
- ② Fascia, showing exhibitor name (as listed in the official trade show catalogue) and stand number
- ③ Grey carpet tiles
- ④ Ceiling plinth
- ⑤ Pole

- Submit Shell Stand Form on PLMA's Exhibitor portal -

## CONTACT GIELISSEN FOR:

- \* Stand necessities: electricity & lighting, furniture, signage, audio-video, shell scheme additional, floor covering, raised floor, water, floral decoration, photography, man power
- \* Position of nearest service ducts
- \* Complete stand packages
- Submit Grid Form on Gielissen's Online Contractor Manual -

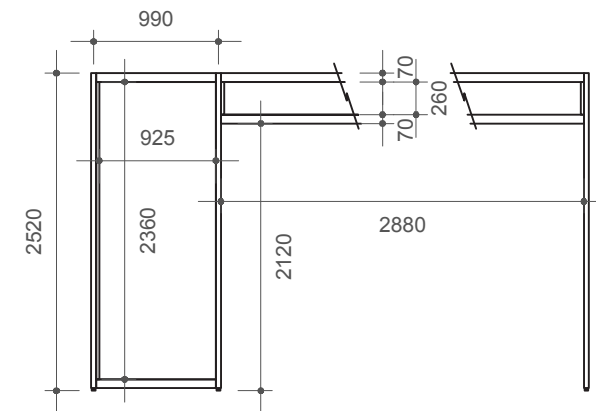

WALL AND FASCIA